

A DETAIL COPLANARITY

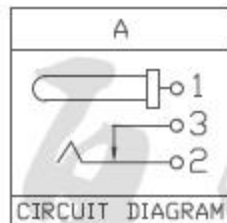

MODEL NO.	C	E
CENTER PIN	∅1.0mm	∅1.3mm

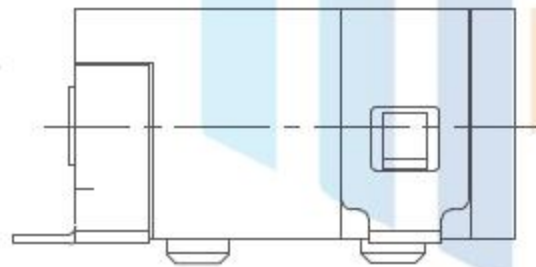
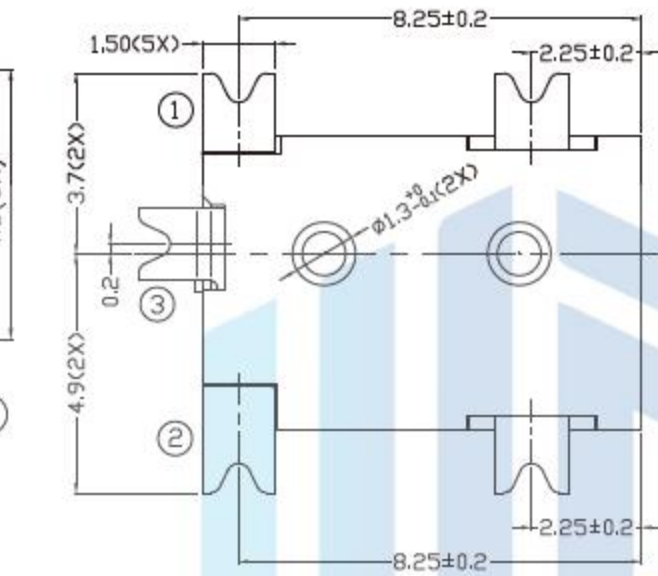
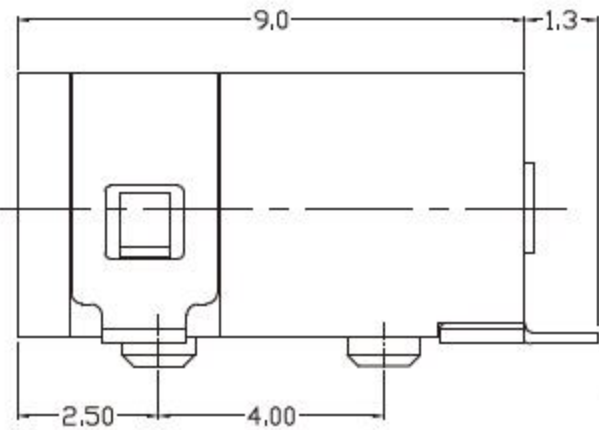
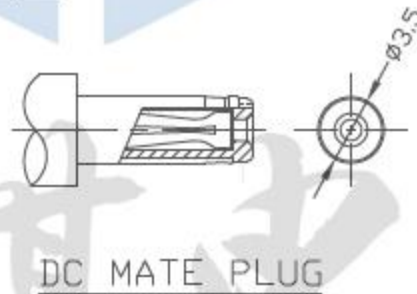

DC MATE PLUG

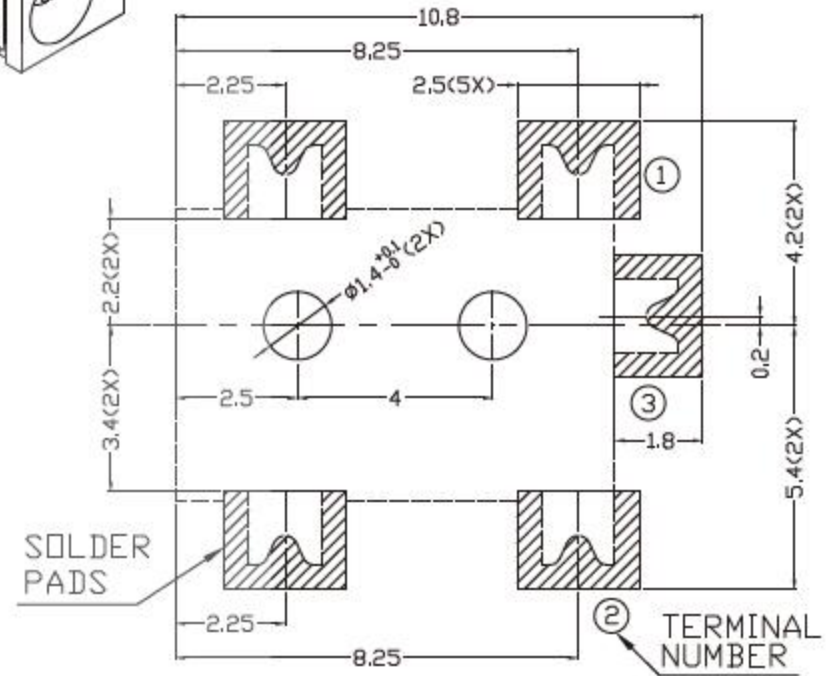
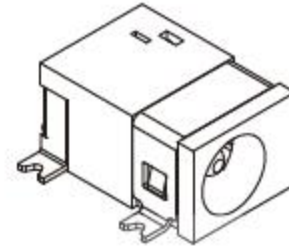

RECOMMENDED P.C.B. LAYOUT
TOLERANCE: ±0.05
(TOP VIEW)

Specification:

1. Rating : 3.5A/16V DC Max.
2. Contact resistance: ≤30mΩ
After test: ≤60mΩ
3. Insulation resistance: ≥100MΩ (DC500V).
After test: ≥50MΩ
4. Withstanding voltage: 500VAC.
5. Insertion and extraction force: 0.3~3Kgs..
6. Life test: 5,000cycles min.
7. Operation temperature range: -25℃~85℃.

设计:	Arvin: 2016.03.08	范围 Range	公差 Tolerance
审核:	Arvin:	X.X ±	X.X ±0.30
校对:	Ru yi:	X.XX ±	X.XX ±0.20
比例:	视角关系:	X.XXX ±	X.XXX ±0.10
版次:	图框大小: A4	Angle ±	Angle ±5°

东莞市恒祺电子科技有限公司

名称: DC插座 型号: DC-092

料号:
共 张 , 第 张 备注: